

BILL OF MATERIAL			
Item No.	Part No.	Description	Quantity
1	10231-010	LOCKBOLT, C50L30-BR20-16Ga	24
2	10231-013	COLLAR, 3LC-2R20GAL	24
3	10342-002	SHOULDER BOLT, 1 1/8" DIA	6
4	10342-007	NUT, 7/8" UNA-DRIV STOVER	6
5	87263-001	TIE, TRANSFER, TOP	3
6	M102546-000	CONNECTION, TOP TIE TO SIDE	6

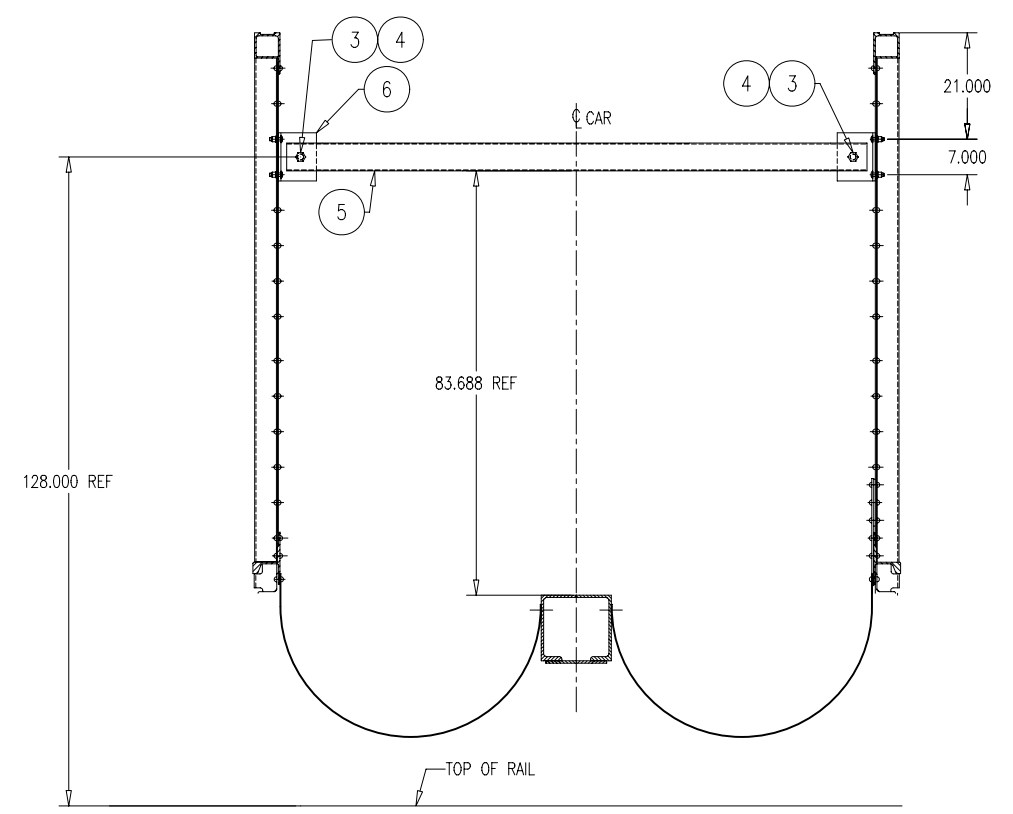

SECTION "A"-"A"
TYPICAL AT STAKES #3, #7, AND #11

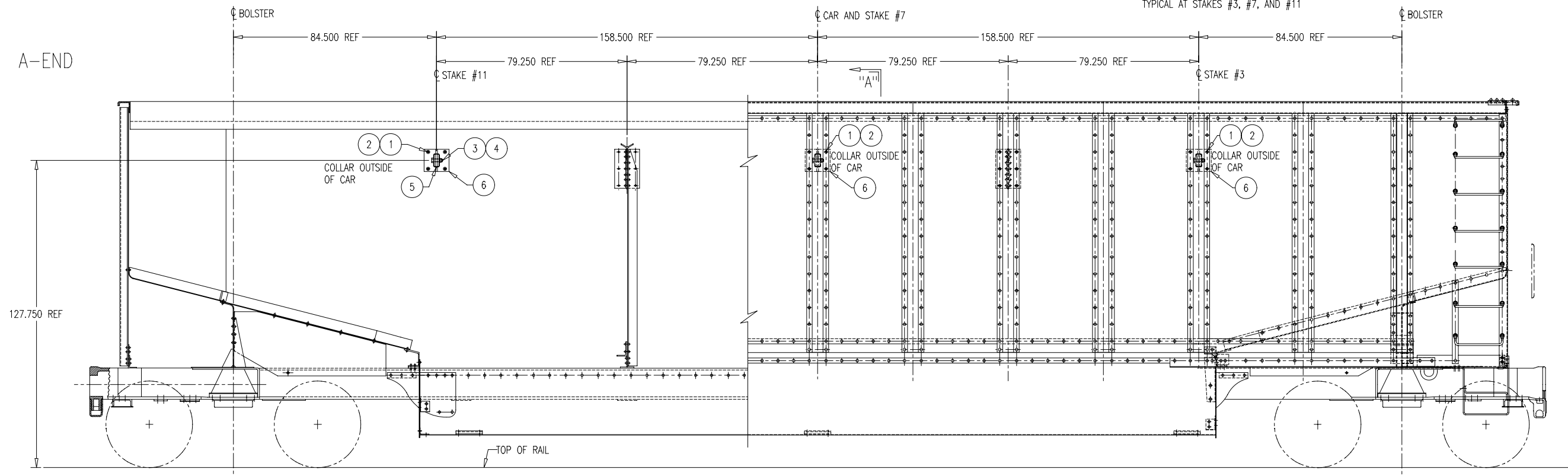

B-END

Level	Date	Approved	Description
REVISIONS			
<i>FreightCar America</i>			
<small>THIS DRAWING IS THE EXCLUSIVE PROPERTY OF FREIGHTCAR AMERICA AND CONTAINS CONFIDENTIAL AND PROPRIETARY INFORMATION. BY ACCEPTING THIS DRAWING, THE RECIPIENT AGREES (A) TO USE THIS DRAWING ONLY FOR THOSE PURPOSES APPROVED IN WRITING BY FREIGHTCAR AMERICA, (B) NOT TO REPRODUCE OR MODIFY THIS DRAWING, IN WHOLE OR IN PART, AND (C) NOT TO DISCLOSE THIS DRAWING TO ANY PERSON OR ENTITY, NOR USE THE DRAWING FOR THE DESIGN OR MANUFACTURE OF ANY ITEM, PART, OBJECT OR APPARATUS THEREOF, EXCEPT UPON THE PRIOR WRITTEN PERMISSION OF FREIGHTCAR AMERICA.</small>			
Standard Tolerances (Unless Noted)			
Fractional dimensions ±1/16"	Hole diameters ±1/32"		Angles ±1°
Decimal dimensions ±0.063"	All dim's in [] are for reference only		Tolerances are not to be accumulative
Diagonals 1/8" max. variation	Radii will be thickness of material		
Made By: BRP/MAP	Date: 08-17-06	Ref. Dwg: E-81173	
Approved: KS			
APPLICATION, TOP TIE, KCPL BETHGON			
Size: D	Drawing/Part Number: A093557-000	Rev.:	-