



Hybrid Center Beam Car

FreightCar America's FlexiBeam™ center beam car is the optimal car for hauling a variety of forest and steel products. FlexiBeam is an all welded, 100-ton capacity flatcar with end bulkheads and a girder of tubular beam construction on the longitudinal centerline. The car has a 286,000 pound gross rail load.

FreightCar America has been a leader in engineering and development of innovative freight car designs for over a century. Contact us to find out more about purchase or lease options for this car and other FreightCar America products.

For more information give us a call at:
800-458-2235 - or - sales@freightcar.net
www.freightcaramerica.com

**FreightCar
America®**

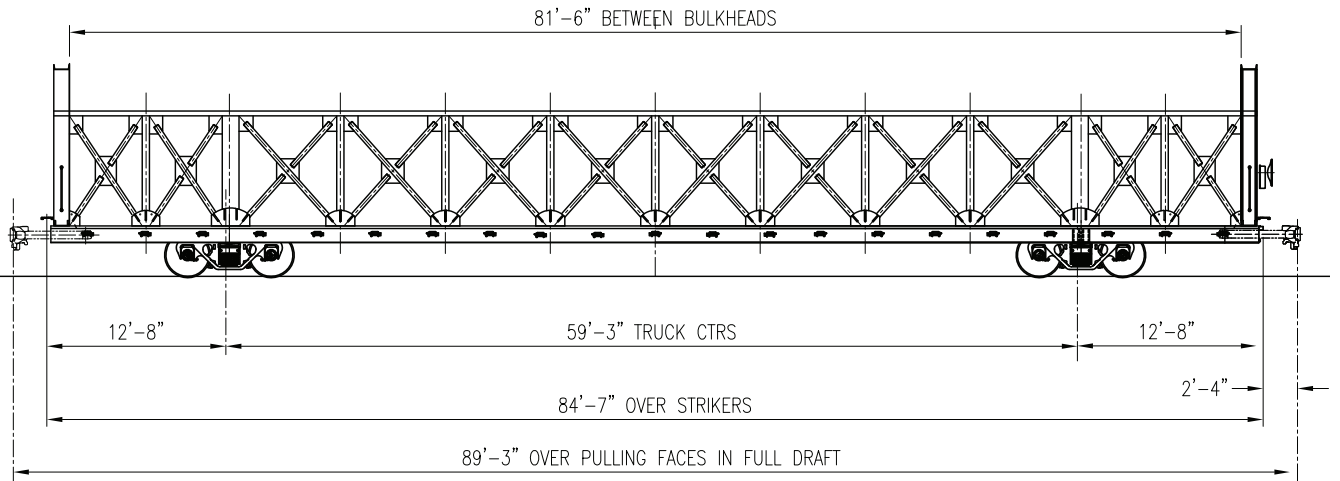

Hybrid Center Beam Car

General Dimensions (Nominal)

Length between bulkheads	81' 6"
Truck centers	59' 3"
Center of truck to striker (overhang).....	12' 8"
Length over strikers.....	84' 7"
Length over pulling face of couplers.....	89' 3"
Width over side sills	9' 8-5/8"
Width over bulkheads	9' 6-5/8"
Height, rail to top of floor	3' 6-9/32"
Height, deck to top of center beam	7' 11-19/32"
Height, deck to top of bulkhead.....	11' 2-11/32"
Height, rail to top of bulkhead	14' 8-5/8"
Lightweight (estimated)	69,500 lbs.
Load limit.....	216,500 lbs.
Center of gravity (empty)	44.7"
Center of gravity (loaded to type of bulkheads @ 286,000 GRL).....	90.6"*

*CG of loaded car was calculated by assuming a lading of uniform density (26.74 lbs./Cu. Ft.) loaded full width and height of bulkhead (less center beam) such that GRL = 286,000 pounds.

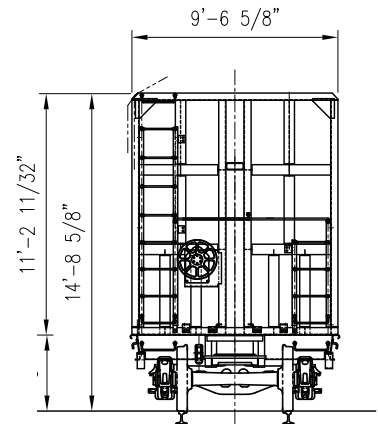
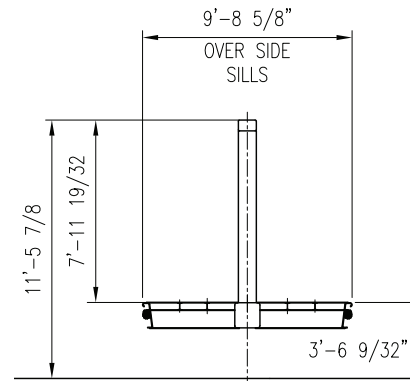

For more information contact us at:

Two North Riverside Plaza, Suite 1300

Chicago, IL 60606

800-458-2235

www.freightcaramerica.com

**FreightCar
America®**